

AD 2 AERODROMES

RJBK AD 2.1 AERODROME LOCATION INDICATOR AND NAME

RJBK - KOHMAN

RJBK AD 2.2 AERODROME GEOGRAPHICAL AND ADMINISTRATIVE DATA

1	ARP coordinates and site at AD	343529N/1335600E
2	Direction and distance from (city)	7.1km S of Okayama city office
3	Elevation/ Reference temperature	0ft / -
4	Geoid undulation at AD ELEV PSN	to be developed
5	MAG VAR/ Annual change	7°W (2000) / 1°W
6	AD Administration, address, telephone, telefax, telex, AFS, e-mail and/or Web-site addresses	OKAYAMA PREF. PUBLIC AP. Address: Urayasuminami-machi 640, Okayama-shi, Okayama Pref. Tel: 086-262-0954 Fax: 086-262-5220 E-mail: kounan@pref.okayama.lg.jp Web: http://www.pref.okayama.jp/soshiki/kakuka.html?sec_sec1=182
7	Types of traffic permitted(IFR/VFR)	VFR
8	Remarks	Nil

RJBK AD 2.3 OPERATIONAL HOURS

1	AD Administration	2330 - 0930
2	Customs and immigration	On request Customs: 0863-31-5375 Immigration: 086-234-3531
3	Health and sanitation	Quarantine(human): On request(086-294-5046) Quarantine(animal, plant): Nil
4	AIS Briefing Office	Nil
5	ATS Reporting Office(ARO)	Nil
6	MET Briefing Office	Nil
7	ATS	2330 - 0930 Kohnan Flight Service
8	Fuelling	0030 - 0830 On Request 2330-0030, 0830-0930 Tel/Fax 086-262-1091
9	Handling	Nil
10	Security	Nil
11	De-icing	Nil
12	Remarks	Nil

RJBK AD 2.4 HANDLING SERVICES AND FACILITIES

1	Cargo-handling facilities	Nil
2	Fuel/ oil types	100/130, JET A-1
3	Fuelling facilities/ capacity	Fuel Truck refueling
4	De-icing facilities	Nil
5	Hangar space for visiting aircraft	Nil
6	Repair facilities for visiting aircraft	Nil
7	Remarks	Nil

RJBK AD 2.5 PASSENGER FACILITIES

1	Hotels	Nil
2	Restaurants	Nil
3	Transportation	Busses
4	Medical facilities	Nil
5	Bank and Post Office	Nil
6	Tourist Office	Nil
7	Remarks	Nil

RJBK AD 2.6 RESCUE AND FIRE FIGHTING SERVICES

1	AD category for fire fighting	CAT 3
2	Rescue equipment	Chemical fire fighting truck x 1
3	Capability for removal of disabled aircraft	Ask AD administration
4	Remarks	Nil

RJBK AD 2.7 SEASONAL AVAILABILITY-CLEARING

1	Types of clearing equipment	Not applicable
2	Clearance priorities	Ask AD administration
3	Remarks	Nil

RJBK AD 2.8 APRONS, TAXIWAYS AND CHECK LOCATIONS DATA

1	Apron surface and strength	Surface : Asphalt-concrete Strength : Apron-1 AUW/5700kg/0.28MPa Apron-2 PCN14/F/D/X/T Apron-3 AUW/5700kg/0.28MPa Apron-4 AUW/11000kg/0.28MPa Apron-5 AUW/4000kg Apron-6 AUW/4000kg
2	Taxiway width, surface and strength	Width: 18m Strength:T1,T3,T4,P1,P2,P3 AUW/5700kg/0.28MPa T2 PCN14/F/D/X/T
3	ACL and elevation	Not available
4	VOR checkpoints	Nil
5	INS checkpoints	Nil
6	Remarks	Nil

RJBK AD 2.9 SURFACE MOVEMENT GUIDANCE AND CONTROL SYSTEM AND MARKINGS

1	Use of aircraft stand ID signs, TWY guide lines and Visual docking/ parking guidance system of aircraft stands	Nil
2	RWY and TWY markings and LGT	RWY:09/27 (Marking) RWY designation, RWY CL, RWY middle point, Aiming point, TDZ, RWY side stripe (LGT) REDL, RTHL, RENL TWY: (Marking) TWY CL, RWY HLDG PSN, TWY side stripe (LGT) TWY edge LGT, Taxiing guidance sign
3	Stop bars	Nil
4	Remarks	(Marking) Apron TWY CL (LGT) Apron flood LGT

RJBK AD 2.10 AERODROME OBSTACLES

- In Area2 See Obstacle data
- In Area3 To be developed

RJBK AD 2.11 METEOROLOGICAL INFORMATION PROVIDED

1	Associated MET Office	Nil
2	Hours of service MET Office outside hours	Nil
3	Office responsible for TAF preparation Periods of validity	Nil
4	Trend forecast Interval of issuance	Nil
5	Briefing/ consultation provided	Nil
6	Flight documentation Language(s) used	Nil
7	Charts and other information available for briefing or consultation	Nil
8	Supplementary equipment available for providing information	Nil
9	ATS units provided with information	Nil
10	Additional information (limitation of service, etc.)	Nil

RJBK AD 2.12 RUNWAY PHYSICAL CHARACTERISTICS

Designations RWY NR	TRUE BRG	Dimensions of RWY(M)	Strength(PCN) and Surface of RWY	THR coordinates THR geoid undulation	THR elevation and highest elevation of TDZ of precision APP RWY
1	2	3	4	5	6
09	085.50°	1200×30	PCN 14/F/D/X/T Asphalt	to be developed	THR ELEV:-1ft
27	265.50°	1200×30	PCN 14/F/D/X/T Asphalt		THR ELEV:2ft
Slope of RWY	Strip Dimensions(M)	RESA (Overrun) Dimensions (M)	Remarks		
7	10	11	14		
See AD chart	1320×120	3×(MNM:117 MAX:120)*	RWY Grooving : 1200m × 20m		
See AD chart	1320×120	40×120	RWY Grooving : 1200m × 20m		
*For detail, ask airport administrator					

RJBK AD 2.13 DECLARED DISTANCES

RWY Designator	TORA (m)	TODA (m)	ASDA (m)	LDA (m)	Remarks
1	2	3	4	5	6
09	1200	1200	1200	1200	Nil
27	1200	1200	1200	1200	Nil

RJBK AD 2.14 APPROACH AND RUNWAY LIGHTING

RWY Designator	APCH LGT type LEN INTST	RTHL Color WBAR	PAPI (VASIS) Angle DIST FM THR MEHT	RTZL LEN	RCLL LEN Spacing Color INTST	REDL LEN Spacing Color INTST	RENL Color WBAR	STWL LEN Color
1	2	3	4	5	6	7	8	9
09	Nil	Green -	PAPI 3.5°/LEFT 230m 45ft	Nil	Nil	1200m 60m Coded color (White/Yellow) LIH	Red -	Nil (*1)
27	Nil	Green -	PAPI 3.5°/LEFT 247m 45ft	Nil	Nil	1200m 60m Coded color (White/Yellow) LIH	Red -	Nil (*1)
Remarks								
10								
Overrun area edge LGT(LEN:60m Color:Red)(*1) RWY THR ID LGT for RWY 09/27 THR (Color: White)								

RJBK AD 2.15 OTHER LIGHTING, SECONDARY POWER SUPPLY

1	ABN/IBN location, characteristics and hours of operation	ABN: 343536N1335556E, White/Green EV4.3sec, HO
2	LDI location and LGT Anemometer location and LGT	LDI: Nil Anemometer : 470m WNW from RWY 27 THR, LGTD
3	TWY edge and centerline lighting	TWY edge LGT: Blue TWY CL LGT: Nil
4	Secondary power supply/ switch-over time	All lights within 15 seconds
5	Remarks	WDI LGT

RJBK AD 2.16 HELICOPTER LANDING AREA

Nil

RJBK AD 2.17 ATS AIRSPACE

Designation and lateral limits	Vertical limits (ft)	Airspace classification	ATS unit call sign Language	Remarks
1	2	3	4	6
Nil				

RJBK AD 2.18 ATS COMMUNICATION FACILITIES

Service designation	Call sign	Frequency	Hours of operation	Remarks
1	2	3	4	5
A/G	KOHANAN FLIGHT SERVICE	130.75MHz	2330 - 0930	Nil

RJBK AD 2.19 RADIO NAVIGATION AND LANDING AIDS

Type of aid	ID	Frequency	Hours of operation	Position of transmitting antenna coordinates	Elevation of DME transmitting antenna	Remarks
1	2	3	4	5	6	7
Nil						

RJBK AD 2.20 LOCAL TRAFFIC REGULATIONS

1. Airport regulations

PPR For use.TEL 086-262-1954

2. Taxiing to and from stands

Nil

3. Parking area for small aircraft(General aviation)

Nil

4. Parking area for helicopters

Nil

5. Apron - taxiing during winter conditions

Nil

6. Taxiing - limitations

Nil

7. School and training flights - technical test flights - use of runways

Nil

8. Helicopter traffic - limitation

Nil

9. Removal of disabled aircraft from runways

Nil

RJBK AD 2.21 NOISE ABATEMENT PROCEDURES

See Kohnan Standard traffic pattern and recommended departure/arrival routes

RJBK AD 2.22 FLIGHT PROCEDURES

The aircraft approaching to Kohnan Aerodrome shall report present position to A/G communication station of Kohnan Aerodrome at 5NM or further from ARP; and receive necessary for the flight.
Call sign and frequency of A/G : KOHNNAN FLIGHT SERVICE, 130.75Hz

RJBK AD 2.23 ADDITIONAL INFORMATION

Nil

RJBK AD 2.24 CHARTS RELATED TO AN AERODROME

Aerodrome/Heliport Chart
Other Chart (Visual REP)
Other Chart (Standard TFC Pattern and DEP/ARR routes)

INTENTIONALLY LEFT BLANK

RJBK / KOHNNAN

AD CHART

CHANGE : Marking on Overrun area.

KOHNNAN AD

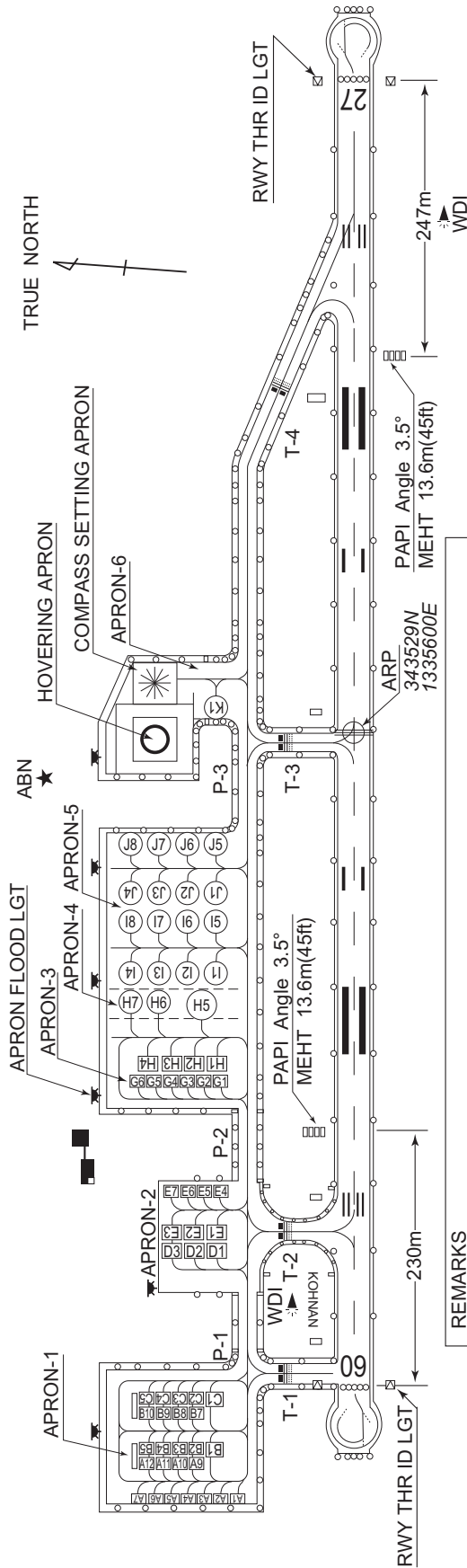

REMARKS

- RWY GROOVING
- STRENGTH OF RWY
- WIDTH OF TWY
- STRENGTH OF TWY T-1,T-3,T-4,P-1,P-2 & P-3
- STRENGTH OF TWY T-2
- DIMENSION & STRENGTH OF APRON
- Apron-1 125m x 139m
- Apron-2 86m x 88m
- Apron-3 82m x 139m
- Apron-4 26m x 121m
- Apron-5 148m x 121m
- Apron-6 54m x 40.5m
- Hovering 66m x 71m
- Compass setting 40m x 40m

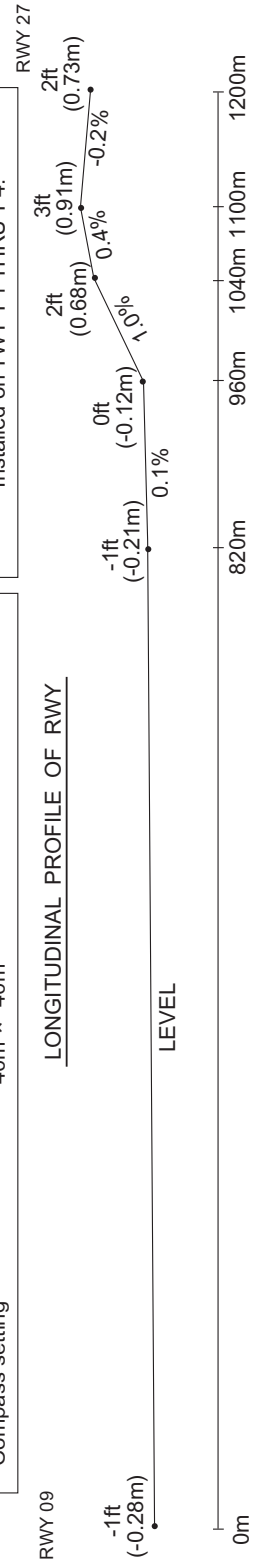
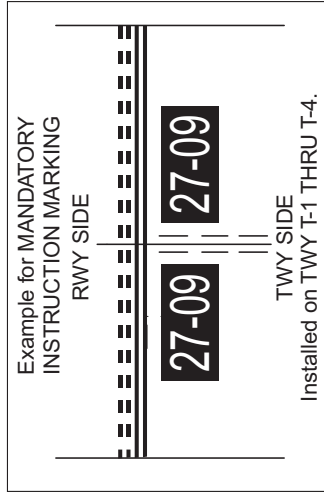

RJBK / KOHNAV

Visual REP

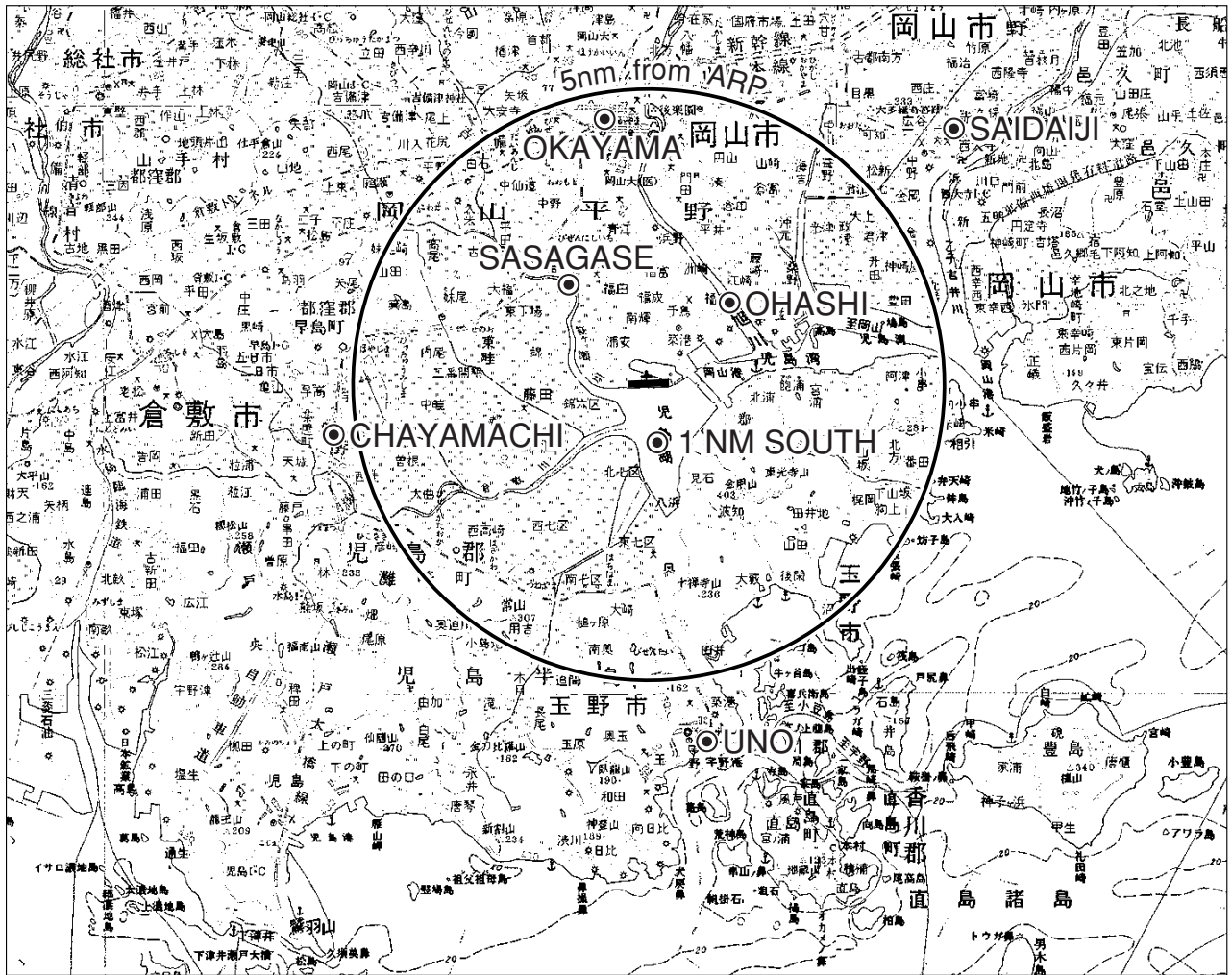

Call sign	BRG / DIST from ARP	Remarks
岡南大橋 Ohashi	054°/2.0NM	旭川橋梁 Asahi River
西大寺 Saidaiji	056°/6.7NM	JR駅 JR Station
宇野 Uno	175°/6.0NM	宇野港 Cape
1マイル南 1 NM South	182°/1.0NM	児島湖 Lake kojima
茶屋町 Chayamachi	267°/5.5NM	JR駅 JR Station
笹ヶ瀬橋 Sasagase	328°/2.2NM	笹ヶ瀬川橋梁 Sasagase River
岡山 Okayama	356°/4.5NM	JR駅 JR Station

注意： 岡南飛行場に進入しようとする飛行機は、飛行場標点から5 NM以遠において位置通報を行い、岡南飛行場の対空通信局から運航に必要な情報の提供を受けること。

対空通信局の呼出符号及び周波数： 岡南Flight Service, 130.75MHz

ATTENTION : The aircraft approaching to Kohnan Aerodrome shall report PPSN to A/G communication station of Kohnan Aerodrome at 5NM or further from ARP; and receive necessary information for the flight.

Call sign and frequency of A/G : KOHNAV FLIGHT SERVICE, 130.75MHz

RJBK / KOHANN

Standard TFC Pattern and DEP/ARR routes

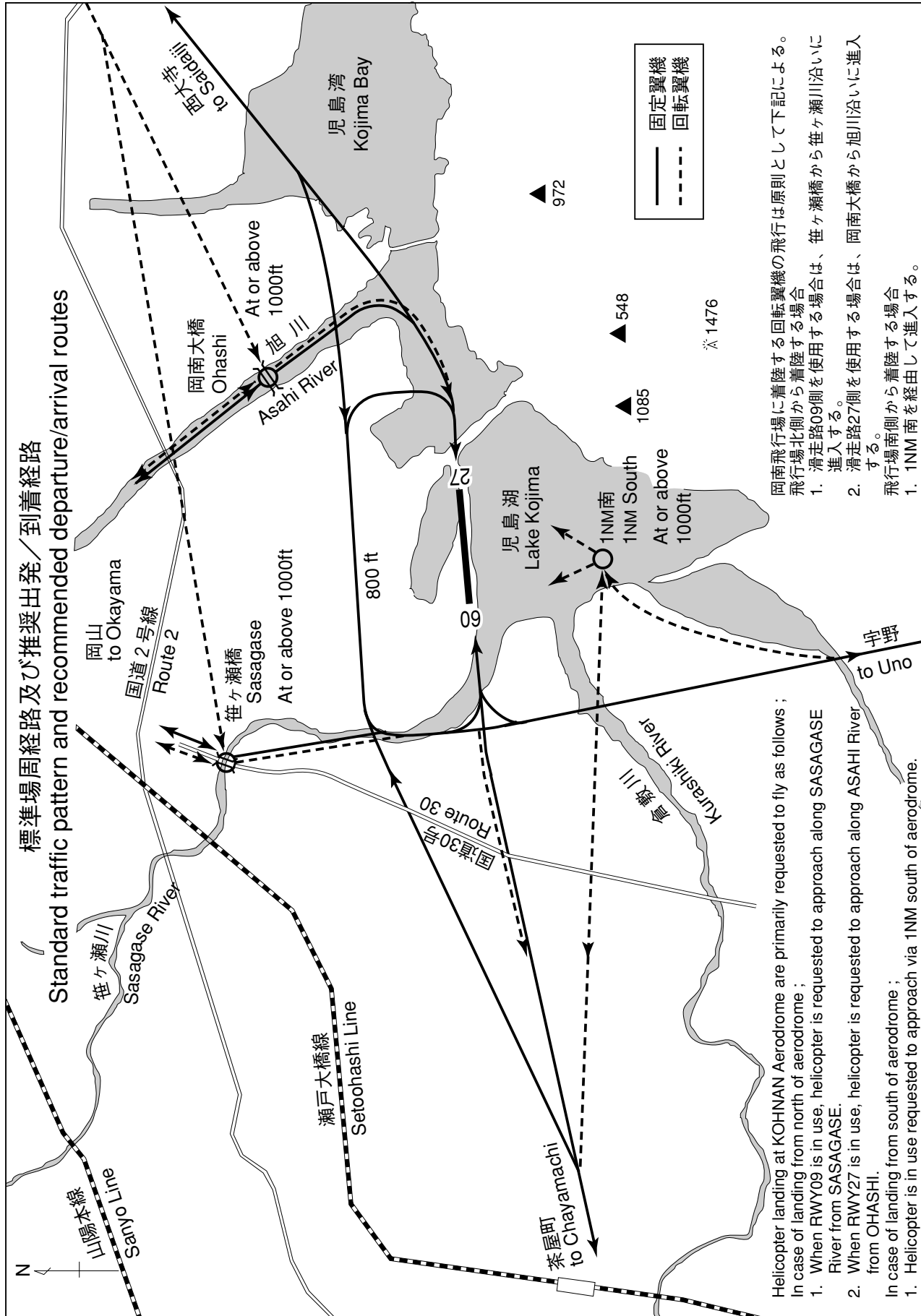

標準場周経路及び推奨出発／到着経路
Standard traffic pattern and recommended departure/arrival routes

岡山飛行場に着陸する回転翼機の飛行は原則として下記による。
飛行場北側から着陸する場合
1. 滑走路09側を使用する場合は、笹ヶ瀬橋から笹ヶ瀬川沿いに進入する。
2. 滑走路27側を使用する場合は、岡南大橋から旭川沿いに進入する。
飛行場南側から着陸する場合
1. 1NM南を經由して進入する。

Helicopter landing at KOHANN Aerodrome are primarily requested to fly as follows ;
In case of landing from north of aerodrome ;
1. When RWY09 is in use, helicopter is requested to approach along SASAGASE River from SASAGASE.
2. When RWY27 is in use, helicopter is requested to approach along ASAHI River from OHASHI.
In case of landing from south of aerodrome ;
1. Helicopter is in use requested to approach via 1NM south of aerodrome.